

800 YARD STREET

Office Leasing Opportunities

GRANDVIEW
YARD



The 800 Yard Street building offers **UNIQUE MULTI-TENANT CLASS A OFFICE SPACE IN A PRIME LOCATION NEAR HOTELS, A CONFERENCE CENTER, AND RESTAURANTS, WITH EASY HIGHWAY ACCESS.**

The 800 Yard building is located at the corner of Goodale Boulevard and Yard Street, the main thoroughfare in Grandview Yard. The 3-story building, anchored by Ernst & Young and Northwestern Mutual, boasts 75,000 square feet of space with ample parking in an adjacent 2-level parking deck with over 500 spaces.

- Located at the intersection of Goodale Boulevard and Yard Street
- 3-story, 75,000 square foot building
- Convenient parking in adjacent 2-level parking deck
- Anchored by Ernst & Young and Northwestern Mutual
- Completed in 2015.

Grandview Yard is a 125-acre mixed-use development featuring a well-planned mix of office, residential, retail, and restaurant uses. Located at the intersection of SR 315 and I-670 in beautiful Grandview Heights, Grandview Yard is just minutes from Downtown Columbus, the Arena District, and The Ohio State University Campus. As evident by the first completed phases, Grandview Yard features appealing architecture, convenient parking, and ample green space. Grandview Yard is proud to be the first development in the Midwest to be certified as a LEED-ND community.

WWW.GRANDVIEWYARD.COM

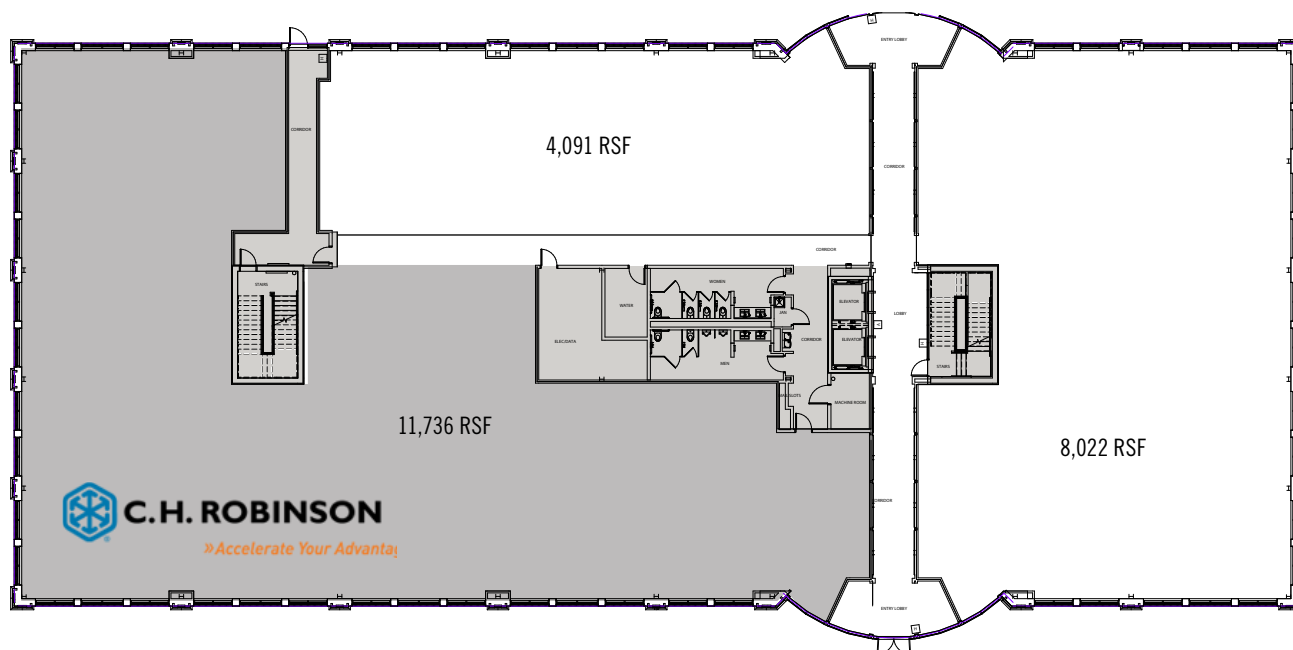

FIRST FLOOR PLAN

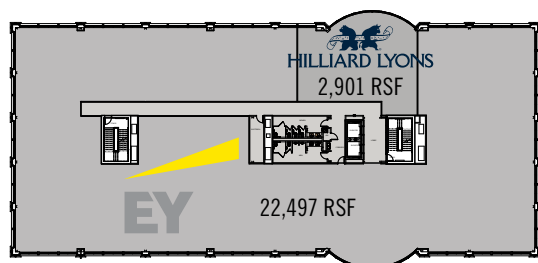

SECOND FLOOR PLAN

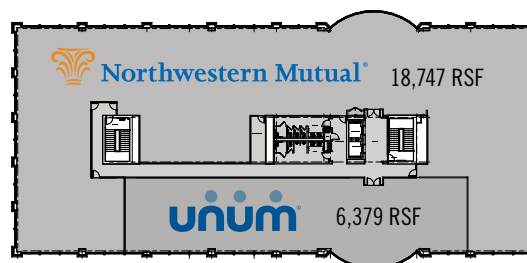

THIRD FLOOR PLAN



Nationwide®

Grandview Yard is owned and developed by Nationwide Realty Investors

375 North Front Street, Suite 200 | Columbus, Ohio 43215

(614) 857-2330 | www.nationwiderealtyinvestors.com

Christopher Bradley: chris.bradley@nationwide.com

FOR LEASING OPPORTUNITIES, CONTACT:



**CONTINENTAL
REALTY**

150 East Broad Street | Columbus, OH 43215

(614) 221-1800 | www.continental-realty.com

For office leasing opportunities contact:

Wayne Harer: wharer@continental-realty.com

Ken Isenbarger: kisenbarger@continental-realty.com

For retail leasing opportunities contact:

Steve Siegel: ssiegel@continental-realty.com

