

MANCHESTER BUILDING

Retail Leasing Opportunities

Adjacent to Nationwide Corporate Campus

GRANDVIEW
YARD



Illustrative Building Rendering



The Manchester building on Yard Street is **ADJACENT TO THE NEW 500,000 SF NATIONWIDE CORPORATE CAMPUS WHICH IS CURRENTLY HOME TO MORE THAN 2500 ASSOCIATES.**

The supremely located building will feature a variety of restaurant and retail offerings on the ground floor and residential on upper floors.

- Prime retail/restaurant space available in +/- 14,000 SF on first floor
- Premier location on Yard Street with easy access from Third Ave
- Adjacent to the new Nationwide campus with more than 2,500 associates. Additional campus buildings will be completed in 2017 and 2019 and will bring the associate total to more than 3,000.
- Convenient on street parking and dedicated spots available on ground level of adjacent garage
- Street-facing patios and prominent signage opportunities available

Grandview Yard is a 125-acre mixed-used development featuring a well-planned mix of office, residential, retail, and restaurant uses. Located at the intersection of SR 315 and I-670 in beautiful Grandview Heights, Grandview Yard is just minutes from Downtown Columbus, the Arena District, and The Ohio State University Campus. As evident by the first completed phases, Grandview Yard features appealing architecture, convenient parking, and ample green space. Grandview Yard is proud to be the first development in the Midwest to be certified as a LEED-ND community.

WWW.GRANDVIEWYARD.COM



FLOOR PLAN

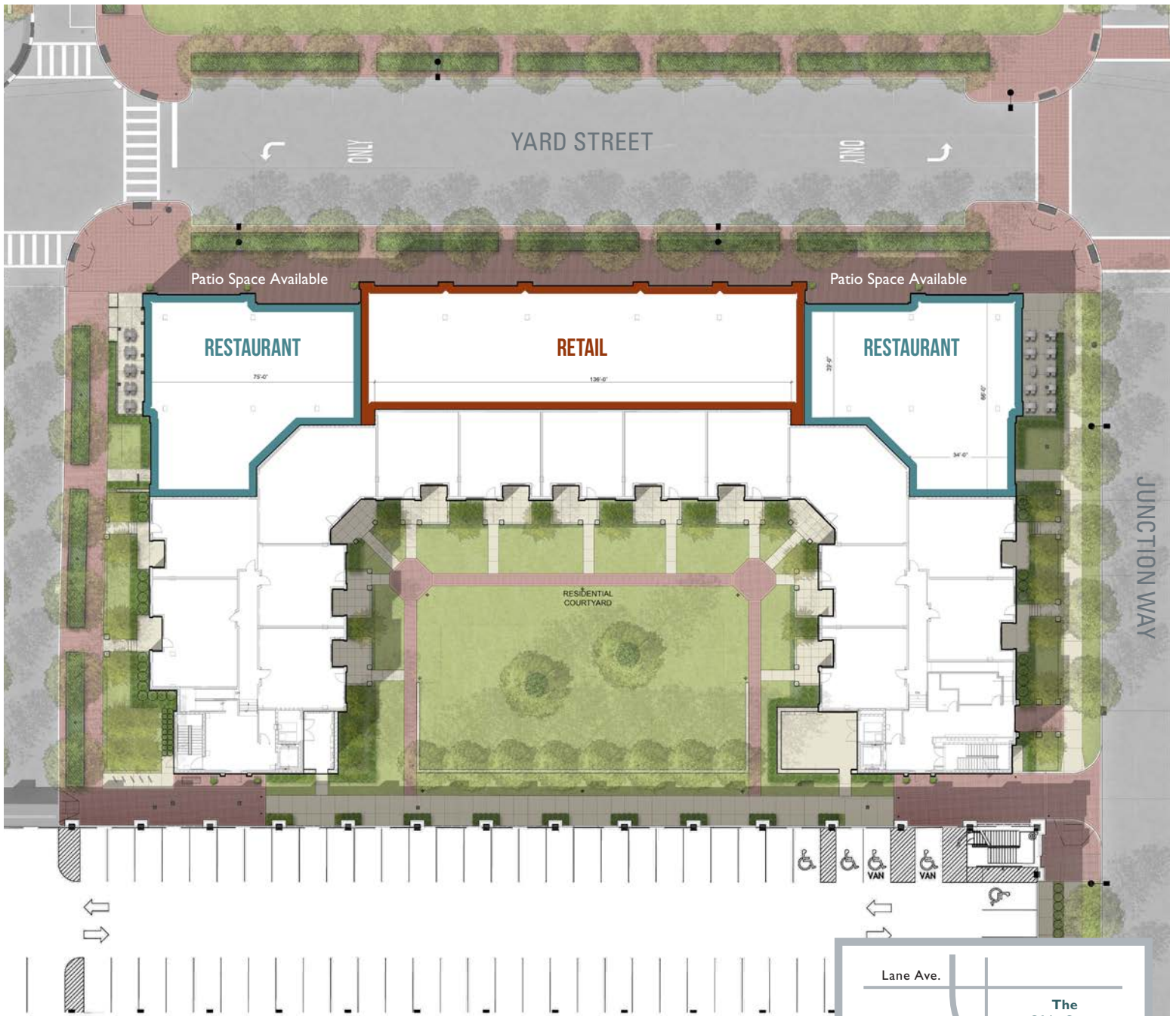

Grandview Yard is owned and developed by Nationwide Realty Investors
 375 North Front Street, Suite 200 | Columbus, Ohio 43215
 (614) 857-2330 | www.nationwiderealtyinvestors.com
 Christopher Bradley: chris.bradley@nationwide.com

FOR LEASING OPPORTUNITIES, CONTACT:

CONTINENTAL REALTY
 150 East Broad Street | Columbus, OH 43215
 (614) 221-1800 | www.continental-realty.com

For office leasing opportunities contact:
 Wayne Harer: wharer@continental-realty.com
 Ken Isenbarger: kisenbarger@continental-realty.com

For retail leasing opportunities contact:
 Steve Siegel: ssiegel@continental-realty.com